

SRI internal connection implants

The SRI implant of cylindrical and self-tapping design provides an excellent solution for those implant placements at bone crest level.

CHARACTERISTICS:

- Cylindrical self tapping implant
- Three-channel connection.
- Micromilling collar
- Double entry thread
- Rounded apex
- Treated surface
- Wide variety of prosthetic solutions.
- Sterile package presentation. With multifunctional fixture mount.



Measures

Ø3,50



Implant Ø3,50x8 SRI



Implant Ø3,50x10 SRI



Implant Ø3,50x11,5 SRI



Implant Ø3,50x13 SRI



Implant Ø3,50x15 SRI

Ø4,30



Implant Ø4,30x8 SRI



Implant Ø4,30x10 SRI



Implant Ø4,30x11,5 SRI



Implant Ø4,30x13 SRI



Implant Ø4,30x15 SRI

Ø5,00



Implant Ø5,00x10 SRI



Implant Ø5,00x11,5 SRI



Implant Ø5,00x13 SRI



Implant Ø5,00x15 SRI

NOTE: "The codes which have the letter M stand for fixture mounted implants"

Placement

Basic instruments for placement

1- Lance drill 2,00 mm	F.0001	12- Twist drill three-edges $\varnothing 4.80$	F.0012
2- Twist drill two-edges $\varnothing 2,00$	F.0002	13- Fixture mount driver for ratchet wrench contra-angle SRI 3,5	DAI.035.M.N. DCI.035.M.N.
3- Pilot drill 2 to 3	F.0022	14- Fixture mount driver for ratchet wrench or contra-angle SRI 4,3	DAI.043.M.N. DCI.043.M.N.
4- Twist drill two-edges $\varnothing 3.00$	F.0005	15- Fixture mount driver for ratchet wrench or contra-angle SRI 5,0	DAI.050.M.N. DCI.050.M.N.
5- Twist drill two-edges $\varnothing 3.15$	F.0006	16- Straight parallel pin	H.0024
6- Twist drill three-edges $\varnothing 3.30$	F.0007	17- Ratchet wrench	H.0006
7- Twist drill three-edges $\varnothing 3.50$	F.0008	18- Hand rotating hexagonal screw driver 0.050" largo	DGH.050.L
8- Twist drill three-edges $\varnothing 3.80$	F.0009		
9- Twist drill three-edges $\varnothing 4.00$	F.0024		
10- Twist drill three-edges $\varnothing 4.30$	F.0010		
11- Twist drill three-edges $\varnothing 4.50$	F.0011		

Drilling protocol and measures

NOTE: *Use in bone type I and II, deepen 2/3 at implant level, use countersink if the situation requires it.

3.50

F.0001 LANCE
F.0002 $\varnothing 2,00$
F.0022 PILOT
F.0005 $\varnothing 3,00$
*F.0006 $\varnothing 3,15$

Bone crest level

4.30

F.0001 LANCE
F.0002 $\varnothing 2,00$
F.0022 PILOT
F.0005 $\varnothing 3,00$
F.0006 $\varnothing 3,15$
F.0007 $\varnothing 3,30$
F.0008 $\varnothing 3,50$
F.0009 $\varnothing 3,80$
*F.0024 $\varnothing 4,00$

Bone crest level

5.00

F.0001 LANCE
F.0002 $\varnothing 2,00$
F.0022 PILOT
F.0005 $\varnothing 3,00$
F.0006 $\varnothing 3,15$
F.0007 $\varnothing 3,30$
F.0008 $\varnothing 3,50$
F.0009 $\varnothing 3,80$
F.0024 $\varnothing 4,00$
F.0010 $\varnothing 4,30$
F.0011 $\varnothing 4,50$
*F.0012 $\varnothing 4,80$

Bone crest level

SRI implant platforms

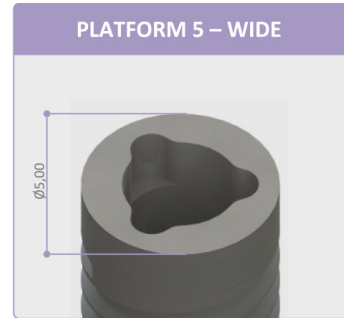
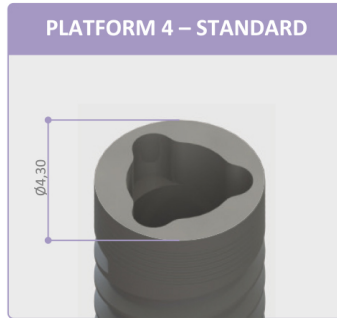
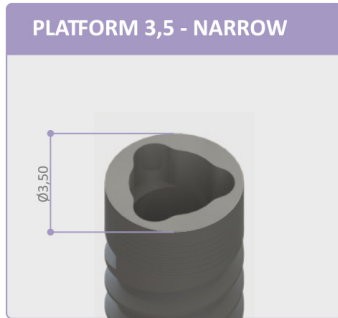

PLATFORM 3,5

PLATFORM 4,3

PLATFORM 5

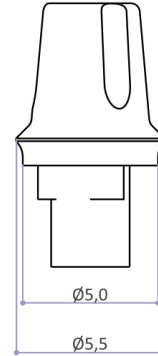
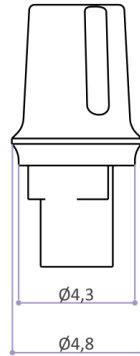
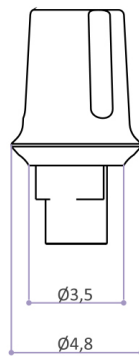

IMPLANT SRI Ø3,50
Platform 3,5 - narrow

IMPLANT SRI Ø4,3
Platform 4,3 - standard

IMPLANT SRI Ø5,0
Platform 5 - wide